



## COOLNET™ PRO

### SUPER-FINE MISTER



#### APPLICATIONS

Super-fine static mister especially designed for cooling and humidifying greenhouses and livestock, and for irrigating over rooting tables.

#### SPECIFICATIONS

- Bridgeless design.
- Static mister, 3 different flow rates: 5.5, 7.5, 14.0 l/h and a plugged nozzle.  
Nominal flow rates at 4.0 bar pressure.
- Pressure range 3.0 - 5.0 bar.
- Recommended filtration : 130 micron / 120 mesh.  
Filtration method is to be selected based on the kind and concentration of the dirt particles existing in the water. Wherever sand exceeding 2 ppm exists in the water, a Hydrocyclone is to be installed before the main filter. When sand/ silt/ clay solids exceed 100 ppm, pre treatment will be applied according to Netafim™ expert team's instructions.
- Inlet connector:  
Press fit
- 3 different configurations:  
Cross, 4 nozzles  
"T" , 2 nozzles  
Straight, 1 nozzle
- The nozzles are code color colored:  
5.5 l/h Light Green  
7.5 l/h Silver Gray  
14.0 l/h Sky Blue  
Plugged nozzle: Orange

#### FEATURES AND BENEFITS

- Bridgeless design eliminates dripping.
- Interchangeable components.
- Acid resistant (AA) raw materials, thus allowing the application chemicals to pass through the system. The system can be cleaned by application of suitable acid treatments.
- Micro sized droplets, at a relatively low pressure of 4.0 bar the CoolNet™ Pro uniformly distributes an average drop size of 65 micron.
- Specially designed for cooling, humidifying and rooting tables.
- Strongly recommended to connect the CoolNet™ Pro to the distribution pipe with a SSPE (super soft PE) micro-tube, a specifically designed stabilizer and AD valve (anti-drain) that will prevent distribution pipe drainage.

## COOLNET™ PRO TECHNICAL DATA

| MODEL | NOZZLE CODE COLOR | NOZZLE SIZE (MM) | RECOMMENDED WORKING PRESSURE (BAR) | CONSTANT K | EXPONENT X |
|-------|-------------------|------------------|------------------------------------|------------|------------|
| 055   | Light Green       | 0.51             | 4.0 to 5.0                         | 1.03       | 0.45       |
| 075   | Silver Gray       | 0.61             | 4.0 to 5.0                         | 1.40       | 0.45       |
| 140   | Sky Blue          | 0.88             | 4.0 to 5.0                         | 2.66       | 0.45       |

## PACKAGING DATA

| COOLNET™ PRO                                   | QUANTITY P/BOX UNITS | BOX SIZE (CM X CM X CM) | BOX WEIGHT (KG) | BOXES P/PALLET | TOTAL UNITS P/PALLET | PALLET WEIGHT (KG) |
|--|----------------------|-------------------------|-----------------|----------------|----------------------|--------------------|
| Head , cross unit with male conn               | 750                  | 18 x 34 x 79            | 11.0            | 20             | 15000                | 220                |
| Complete stand (30 cm) w/stabilizer & AD valve | 125                  | 28 x 28 x 57            | 8.4             | 32             | 4000                 | 269                |
| Complete stand (60 cm) w/stabilizer & AD valve | 100                  | 18 x 34 x 79            | 8.2             | 20             | 2000                 | 185                |
| Head , T unit with male conn                   | 1000                 | 28 x 28 x 57            | 14.8            | 32             | 32000                | 474                |
| Complete stand (30 cm) w/stabilizer & AD valve | 150                  | 28 x 28 x 57            | 9.9             | 32             | 4800                 | 317                |
| Complete stand (60 cm) w/stabilizer & AD valve | 100                  | 18 x 34 x 79            | 8.2             | 20             | 2000                 | 173                |
| Head , one outlet                              | 5000                 | 18 x 34 x 79            | 21.5            | 20             | 100000               | 430                |

## COOLNET™ PRO

Flowchart to determine the desired product definition

How to use: To determine the desired product definition select one of every set of options displayed on the chart.

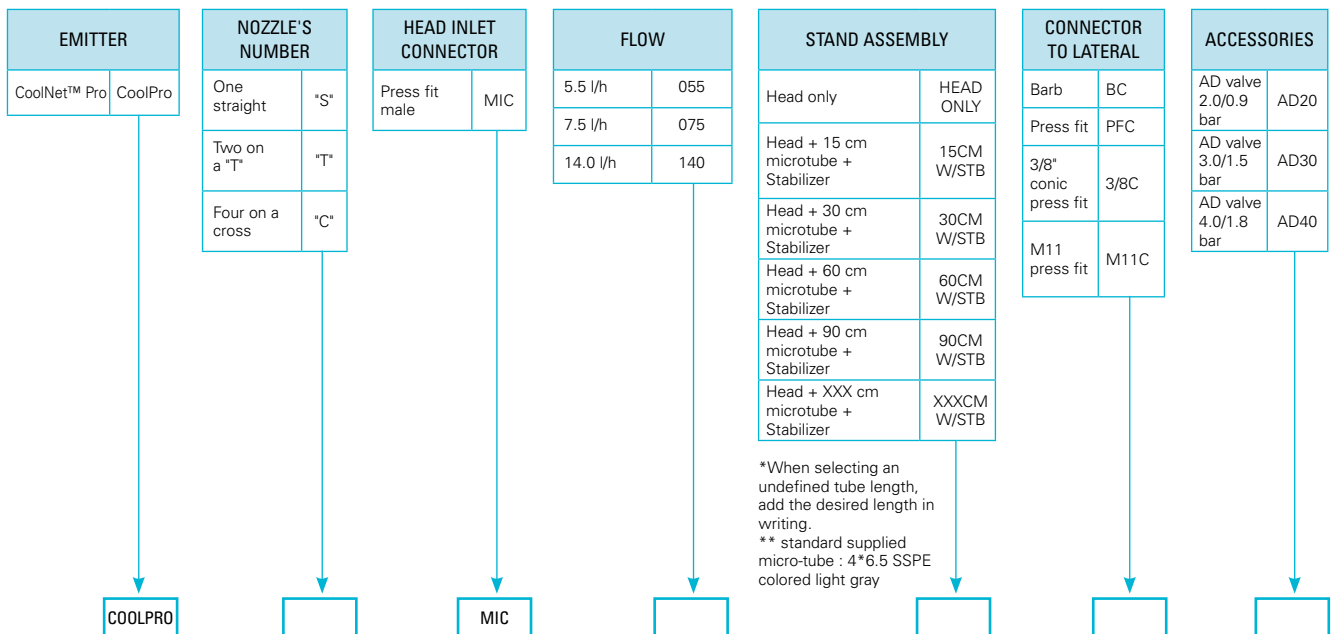

## COOLNET™ PRO

Head only (with male inlet connector)

Catalog number: **63100** - (any of below 6 digits )

| MODEL | SINGLE | TEE    | CROSS  |
|-------|--------|--------|--------|
|       | "S"    | "T"    | "C"    |
| 055   | 048600 | 050000 | 052000 |
| 075   | 054000 | 056300 | 058300 |
| 140   | 055900 | 055950 | 055980 |

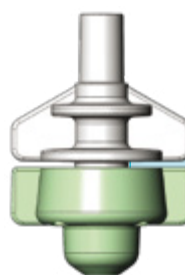

CoolNet™ Pro Single

## COOLNET™ PRO

head + AD valve 40

Catalog number: **63100** - (any of below 6 digits )

| MODEL | SINGLE | TEE    | CROSS  |
|-------|--------|--------|--------|
|       | "S"    | "T"    | "C"    |
| 055   | 049420 | 050010 | 052200 |
| 075   |        |        | 058500 |
| 140   | 056330 | 059420 | 055985 |

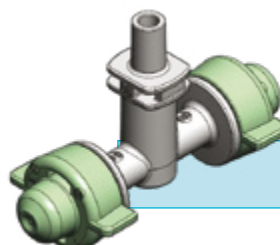

CoolNet™ Pro Tee

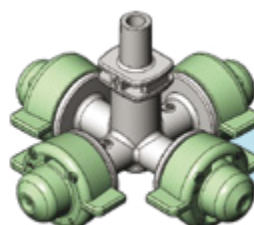

CoolNet™ Pro Cross

## COOLNET™ PRO ASSEMBLY STANDS

CoolNet™ Pro , UD stand, model "S" , Flow YYY , micro-tube length XXX , stabilizer , barb connector to lateral pipe , AD valve 40 , Catalog number : **63100** - (any of below 6 digits)

| MODEL | 15 CM  | 30 CM  | 60 CM | 90 CM |
|-------|--------|--------|-------|-------|
| 055   | 049000 | 049400 |       |       |
| 075   | 054300 | 055100 |       |       |
| 140   |        |        |       |       |

CoolNet™ Pro , UD stand, model "S" , Flow YYY , micro-tube length XXX , stabilizer , press-fit connector to lateral pipe , AD valve 40 , Catalog number : **63100** - (any of below 6 digits)

| MODEL | 15 CM  | 30 CM  | 60 CM | 90 CM |
|-------|--------|--------|-------|-------|
| 055   |        |        |       |       |
| 075   | 054600 | 055800 |       |       |
| 140   |        |        |       |       |

CoolNet™ Pro , UD stand, model "T" , Flow YYY , micro-tube length XXX , stabilizer , barb connector to lateral pipe , AD valve 40 , Catalog number : **63100** - (any of below 6 digits)

| MODEL | 15 CM  | 30 CM  | 60 CM | 90 CM |
|-------|--------|--------|-------|-------|
| 055   | 050300 | 050700 |       |       |
| 075   | 056700 | 057100 |       |       |
| 140   |        |        |       |       |

CoolNet™ Pro , UD stand, model "T" , Flow YYY , micro-tube length XXX , stabilizer , press-fit connector to lateral pipe , AD valve 40 , Catalog number : **63100** - (any of below 6 digits)

| MODEL | 15 CM | 30 CM  | 60 CM  | 90 CM |
|-------|-------|--------|--------|-------|
| 055   |       | 050900 | 051100 |       |
| 075   |       | 057300 |        |       |
| 140   |       |        |        |       |

CoolNet™ Pro , UD stand, model "C" , Flow YYY , micro-tube length XXX , stabilizer , barb connector to lateral pipe, AD valve 40 , Catalog number : **63100** - (any of below 6 digits)

| MODEL | 15 CM  | 30 CM  | 60 CM  | 90 CM  |
|-------|--------|--------|--------|--------|
| 055   | 052400 | 053100 | 053960 | 053980 |
| 075   | 058900 | 059600 | 069960 |        |
| 140   |        |        |        |        |

CoolNet™Pro , UD stand, model "C" , Flow YYY , micro-tube length XXX , stabilizer , press-fit connector to lateral pipe , AD valve 40 , Catalog number : **63100** - (any of below 6 digits)

| MODEL | 15 CM  | 30 CM  | 60 CM  | 90 CM  |
|-------|--------|--------|--------|--------|
| 055   | 052700 | 053500 | 053965 |        |
| 075   | 059200 | 060000 | 070200 |        |
| 140   | 055990 | 055991 |        | 071010 |

Missing catalog numbers available upon request. All assembly stands include 4\*6.5 mm gray SSPE micro-tube.  
Other stand combinations can be ordered based on the attached flowchart which can help determine the desired product requirement.